

Customer Care Solutions

NPM-6/6X Series Transceivers

Parts List

[This page left intentionally blank]

Table of Contents

	Page No
Exploded View of Nokia NPM-6/6X	4
Mechanical parts list	5
Parts list NPM-6.....	6
Parts list NPM-6X.....	13

Exploded View of Nokia NPM-6/6X

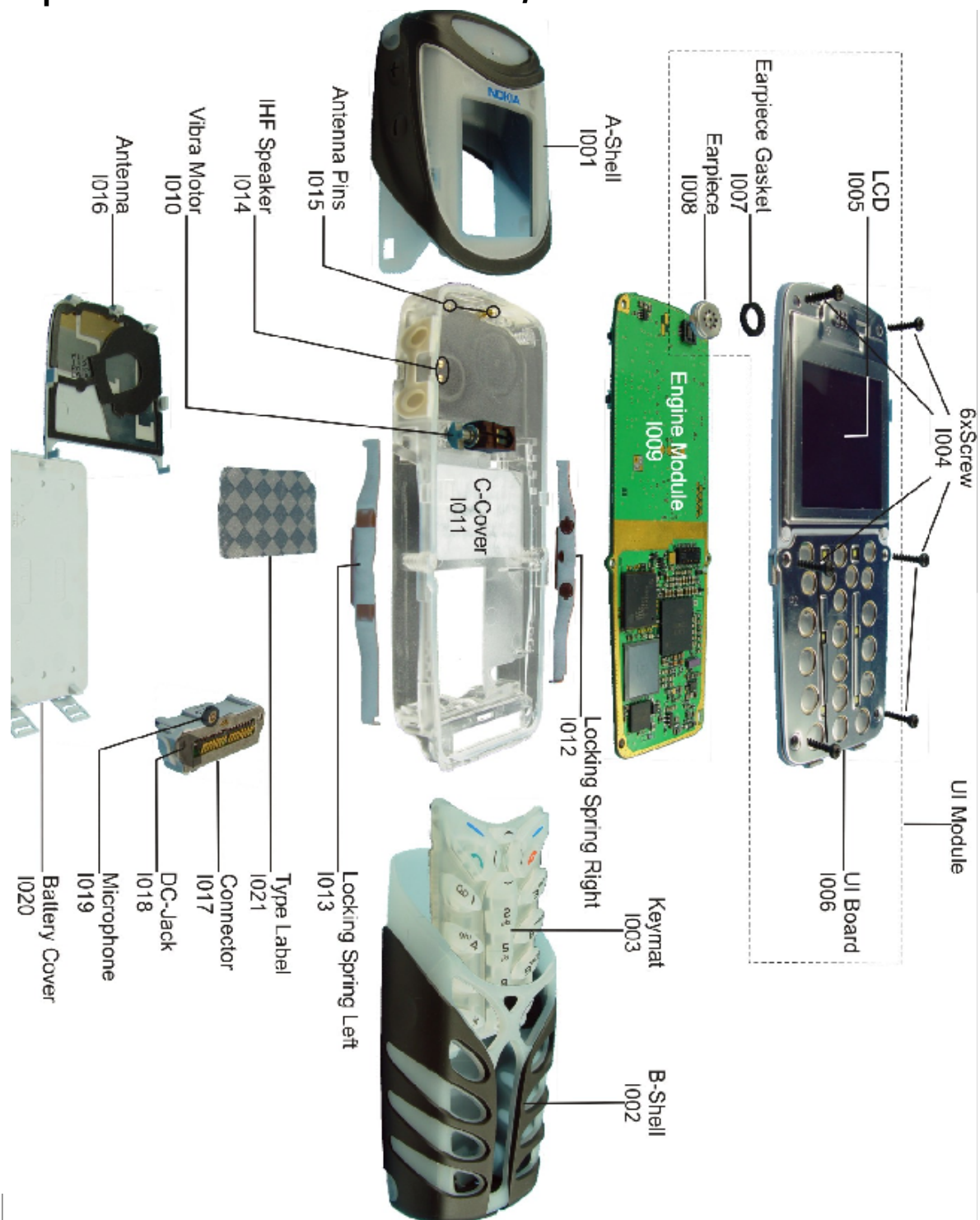

Mechanical parts list

MECHANICAL PARTS

ITEM/ CIRCUIT REF.	QTY	PART NO	PART NAME
I004	6	6150099	SCREWS
	1	9458503	UI MODULE ASSY (I005-I008)
I005	1	XXXXXXX	LCD
I006	1	XXXXXXX	UI BOARD ASSY
I007	1	9470283	EARPIECE GASKET
I008	1	5140251	EARPIECE
	1	XXXXXXX	AK-4 FOXY ENGINE MODULE
I010	1	6800055	VIB MOTOR
		0263050	C-COVER/ANTENNA ASSY PARTS (I011-I016) FOR NPM-6X
I011		XXXXXXX	C-COVER
I012	1	XXXXXXX	LOCKING SPRING RIGHT
I013	1	XXXXXXX	LOCKING SPRING LEFT
I014	1	XXXXXXX	IHF SPEAKER
I015	1	XXXXXXX	ANTENNA PINS
I016	1	XXXXXXX	ANTENNA
		0262979	C-COVER/ANTENNA ASSY PARTS (I011-I016) FOR NPM-6
I011		XXXXXXX	C-COVER
I012	1	XXXXXXX	LOCKING SPRING RIGHT
I013	1	XXXXXXX	LOCKING SPRING LEFT
I014	1	XXXXXXX	IHF SPEAKER
I015	1	XXXXXXX	ANTENNA PINS
I016	1	XXXXXXX	ANTENNA
	1	5400257	CONNECTOR ASSY (I017-I019)
I017	1	XXXXXXX	CONNECTOR
I018	1	XXXXXXX	DC-JACK
I019	1	XXXXXXX	Mic
I020	1	9458473	BATTERY-COVER
I021	1	9370967	BLANK LABEL ROLL 2500

VARIANT PARTS

ITEM/ CIRCUIT REF.	QTY	PART NO	PART NAME
I001	1	9458884	A-SHELL ASSEMBLY DARK GREY
I001	1	9458885	A-SHELL ASSEMBLY GREEN
I001	1	9458886	A-SHELL ASSEMBLY BLUE
I002	1	9458890	B-SHELL ASSEMBLY DARK GREY
I002	1	9458891	B-SHELL ASSEMBLY GREEN
I002	1	9458892	B-SHELL ASSEMBLY BLUE
I003	1	9458517	PRINTED KEYMAT LATIN
I003	1	9790847	PRINTED KEYMAT ARABIC
I003	1	9790851	PRINTED KEYMAT CYRILLIC
I003	1	9790852	PRINTED KEYMAT GREEK
I003	1	9790853	PRINTED KEYMAT HEBREW

Parts list NPM-6

ITEM	CODE	SIDE	X	Y	VALUE	PART NUMBER	VALUE	VALUE
A1	9517174	Bottom	O	6	SHIELD_DMC01304	NECTAR SHIELD ASSY DMC04525 NHL-4	~	~
A2	9458467	Bottom	J	4	SHIELD_DMC04970	SHIELDING CAN RF ASSY DMC04970-EN	~	~
A3	9517151	Bottom	D	5	SHIELD_DMC04061	HELGA SHIELD ASSY DMC04061 NHL-4	~	~
B200	4510219	Top	Q	6	CRYSTAL_CX_4V	CRYSTAL 32.768KHZ+-30PPM 9PF	32.768kHz	~
B300	5140247	Top	A	4	SPEAKER_WD2039832	SPEAKER 105+-3DB 32R D8X3MM PICO	~	~
C100	2320546	Bottom	H	7	0402C	Chipcap 5% NP0	27p	50V
C101	2320481	Top	S	4	0603C	CHIPCAP X5R 1U K 6V3 0603	1u0	6.3V
C102	2320481	Top	R	5	0603C	CHIPCAP X5R 1U K 6V3 0603	1u0	6.3V
C103	2321013	Top	R	5	0402C	CHIPCAP NP0 270P J 25V 0402	270p	25V
C104	2315201	Top	R	5	0405_2_P0.65	CHIP ARRAY NP0 2X27P K 25V 0405	2x27p	25V
C106	2320744	Top	R	4	0402C	Chipcap X7R 10% 50V 0402	1n0	50V
C107	2320536	Top	S	6	0402C	Chipcap 5% NP0	10p	50V
C108	2320536	Top	S	6	0402C	Chipcap 5% NP0	10p	50V
C109	2320536	Top	T	6	0402C	Chipcap 5% NP0	10p	50V
C110	2320544	Top	R	4	0402C	Chipcap 5% NP0	22p	50V
C112	2320778	Top	S	5	0402C	Chipcap X7R 10% 16V 0402	10n	16V
C113	2320756	Top	S	6	0402C	Chipcap X7R 10% 50V 0402	3n3	50V
C114	2320756	Top	S	6	0402C	Chipcap X7R 10% 50V 0402	3n3	50V
C115	2320756	Top	T	5	0402C	Chipcap X7R 10% 50V 0402	3n3	50V
C116	2320756	Top	T	5	0402C	Chipcap X7R 10% 50V 0402	3n3	50V
C117	2320536	Top	T	6	0402C	Chipcap 5% NP0	10p	50V
C118	2320756	Top	S	7	0402C	Chipcap X7R 10% 50V 0402	3n3	50V
C119	2320756	Top	S	6	0402C	Chipcap X7R 10% 50V 0402	3n3	50V
C150	2320805	Top	P	5	0402C	CHIPCAP X5R 100N K 10V 0402	100n	10V
C151	2315205	Top	Q	6	0405_2_P0.65_AVX	CHIP ARRAY X5R 2X1N M 16V 0405	2x1n	16V
C152	2320805	Top	P	5	0402C	CHIPCAP X5R 100N K 10V 0402	100n	10V
C153	2315209	Top	P	6	0405_2_P0.65_AVX	CHIP ARRAY X5R 2X33N M 10V 0405	2x33n	10V
C154	2315209	Top	P	5	0405_2_P0.65_AVX	CHIP ARRAY X5R 2X33N M 10V 0405	2x33n	10V
C155	2315201	Top	A	2	0405_2_P0.65	CHIP ARRAY NP0 2X27P K 25V 0405	2x27p	25V
C156	2315205	Top	Q	5	0405_2_P0.65_AVX	CHIP ARRAY X5R 2X1N M 16V 0405	2x1n	16V
C157	2315201	Top	R	6	0405_2_P0.65	CHIP ARRAY NP0 2X27P K 25V 0405	2x27p	25V
C158	2315201	Top	R	6	0405_2_P0.65	CHIP ARRAY NP0 2X27P K 25V 0405	2x27p	25V
C159	2315201	Top	S	5	0405_2_P0.65	CHIP ARRAY NP0 2X27P K 25V 0405	2x27p	25V
C160	2320805	Top	Q	7	0402C	CHIPCAP X5R 100N K 10V 0402	100n	10V
C161	2320805	Top	R	7	0402C	CHIPCAP X5R 100N K 10V 0402	100n	10V
C162	2320805	Top	Q	6	0402C	CHIPCAP X5R 100N K 10V 0402	100n	10V
C163	2320805	Top	R	7	0402C	CHIPCAP X5R 100N K 10V 0402	100n	10V
C165	2320805	Bottom	N	7	0402C	CHIPCAP X5R 100N K 10V 0402	100n	10V
C166	2320481	Top	Q	7	0603C	CHIPCAP X5R 1U K 6V3 0603	1u0	6.3V
C167	2320481	Top	R	7	0603C	CHIPCAP X5R 1U K 6V3 0603	1u0	6.3V
C168	2320805	Bottom	P	5	0402C	CHIPCAP X5R 100N K 10V 0402	100n	10V
C169	2320805	Top	R	6	0402C	CHIPCAP X5R 100N K 10V 0402	100n	10V
C170	2320544	Bottom	D	1	0402C	Chipcap 5% NP0	22p	50V
C171	2320544	Bottom	E	1	0402C	Chipcap 5% NP0	22p	50V
C172	2320544	Bottom	C	1	0402C	Chipcap 5% NP0	22p	50V
C173	2320538	Top	Q	6	0402C	Chipcap 5% NP0	12p	50V
C174	2320538	Top	Q	6	0402C	Chipcap 5% NP0	12p	50V
C175	2320538	Top	Q	6	0402C	Chipcap 5% NP0	12p	50V
C177	2320805	Top	Q	5	0402C	CHIPCAP X5R 100N K 10V 0402	100n	10V
C200	2320805	Top	N	7	0402C	CHIPCAP X5R 100N K 10V 0402	100n	10V
C201	2320481	Top	M	7	0603C	CHIPCAP X5R 1U K 6V3 0603	1u0	6.3V
C202	2320778	Top	M	7	0402C	Chipcap X7R 10% 16V 0402	10n	16V
C203	2320481	Top	P	4	0603C	CHIPCAP X5R 1U K 6V3 0603	1u0	6.3V
C204	2320481	Top	O	6	0603C	CHIPCAP X5R 1U K 6V3 0603	1u0	6.3V
C205	2320481	Top	O	6	0603C	CHIPCAP X5R 1U K 6V3 0603	1u0	6.3V
C206	2320481	Top	O	6	0603C	CHIPCAP X5R 1U K 6V3 0603	1u0	6.3V
C207	2320481	Top	Q	4	0603C	CHIPCAP X5R 1U K 6V3 0603	1u0	6.3V
C208	2320481	Top	M	6	0603C	CHIPCAP X5R 1U K 6V3 0603	1u0	6.3V
C209	2320536	Top	P	6	0402C	Chipcap 5% NP0	10p	50V

ITEM	CODE	SIDE	X	Y	VALUE	PART NUMBER	VALUE	VALUE
C210	2320536	Top	P	6	0402C	Chipcap 5% NP0	10p	50V
C211	2320481	Top	P	6	0603C	CHIPCAP X5R 1U K 6V3 0603	1u0	6.3V
C212	2320481	Top	P	6	0603C	CHIPCAP X5R 1U K 6V3 0603	1u0	6.3V
C213	2320481	Top	P	7	0603C	CHIPCAP X5R 1U K 6V3 0603	1u0	6.3V
C214	2320481	Top	P	7	0603C	CHIPCAP X5R 1U K 6V3 0603	1u0	6.3V
C215	2320481	Top	Q	5	0603C	CHIPCAP X5R 1U K 6V3 0603	1u0	6.3V
C218	2320805	Top	O	4	0402C	CHIPCAP X5R 100N K 10V 0402	100n	10V
C219	2320125	Top	M	6	0603C	CHIPCAP X5R 1U K 16V 0603	1u0	16V
C220	2320778	Bottom	M	5	0402C	Chipcap X7R 10% 16V 0402	10n	16V
C221	2320481	Top	M	6	0603C	CHIPCAP X5R 1U K 6V3 0603	1u0	6.3V
C222	2320481	Top	L	5	0603C	CHIPCAP X5R 1U K 6V3 0603	1u0	6.3V
C223	2320481	Top	L	6	0603C	CHIPCAP X5R 1U K 6V3 0603	1u0	6.3V
C224	2320481	Top	M	5	0603C	CHIPCAP X5R 1U K 6V3 0603	1u0	6.3V
C225	2320481	Top	M	6	0603C	CHIPCAP X5R 1U K 6V3 0603	1u0	6.3V
C226	2320481	Top	M	4	0603C	CHIPCAP X5R 1U K 6V3 0603	1u0	6.3V
C227	2320481	Top	L	5	0603C	CHIPCAP X5R 1U K 6V3 0603	1u0	6.3V
C228	2320481	Top	M	4	0603C	CHIPCAP X5R 1U K 6V3 0603	1u0	6.3V
C229	2320481	Top	M	4	0603C	CHIPCAP X5R 1U K 6V3 0603	1u0	6.3V
C230	2320481	Top	M	5	0603C	CHIPCAP X5R 1U K 6V3 0603	1u0	6.3V
C231	2320481	Top	M	5	0603C	CHIPCAP X5R 1U K 6V3 0603	1u0	6.3V
C232	2320481	Top	M	5	0603C	CHIPCAP X5R 1U K 6V3 0603	1u0	6.3V
C233	2320481	Top	L	6	0603C	CHIPCAP X5R 1U K 6V3 0603	1u0	6.3V
C234	2320481	Top	M	5	0603C	CHIPCAP X5R 1U K 6V3 0603	1u0	6.3V
C235	2320481	Top	P	7	0603C	CHIPCAP X5R 1U K 6V3 0603	1u0	6.3V
C236	2320805	Top	M	4	0402C	CHIPCAP X5R 100N K 10V 0402	100n	10V
C237	2320805	Top	M	4	0402C	CHIPCAP X5R 100N K 10V 0402	100n	10V
C238	2320805	Top	N	6	0402C	CHIPCAP X5R 100N K 10V 0402	100n	10V
C239	2320805	Top	P	4	0402C	CHIPCAP X5R 100N K 10V 0402	100n	10V
C240	2320778	Top	P	4	0402C	Chipcap X7R 10% 16V 0402	10n	16V
C241	2320744	Top	Q	4	0402C	Chipcap X7R 10% 50V 0402	1n0	50V
C243	2320481	Top	Q	5	0603C	CHIPCAP X5R 1U K 6V3 0603	1u0	6.3V
C245	2320778	Top	L	7	0402C	Chipcap X7R 10% 16V 0402	10n	16V
C246	2320778	Top	L	7	0402C	Chipcap X7R 10% 16V 0402	10n	16V
C260	2320481	Top	O	7	0603C	CHIPCAP X5R 1U K 6V3 0603	1u0	6.3V
C261	2320481	Top	O	7	0603C	CHIPCAP X5R 1U K 6V3 0603	1u0	6.3V
C262	2320481	Top	M	6	0603C	CHIPCAP X5R 1U K 6V3 0603	1u0	6.3V
C263	2320481	Top	M	5	0603C	CHIPCAP X5R 1U K 6V3 0603	1u0	6.3V
C264	2320481	Top	M	6	0603C	CHIPCAP X5R 1U K 6V3 0603	1u0	6.3V
C265	2320481	Top	Q	4	0603C	CHIPCAP X5R 1U K 6V3 0603	1u0	6.3V
C302	2320556	Bottom	J	7	0402C	Chipcap 5% NP0	68p	50V
C303	2320481	Bottom	I	6	0603C	CHIPCAP X5R 1U K 6V3 0603	1u0	6.3V
C304	2312249	Bottom	H	7	0805C	CHIPCAP X5R 4U7 K 10V 0805	4u7	10V
C307	2320536	Bottom	H	3	0402C	Chipcap 5% NP0	10p	50V
C308	2320536	Bottom	H	3	0402C	Chipcap 5% NP0	10p	50V
C310	2320544	Bottom	A	5	0402C	Chipcap 5% NP0	22p	50V
C350	2312243	Bottom	Q	6	0805C	CHIPCAP X5R 4U7 K 6V3 0805	4u7	6V3
C352	2320805	Bottom	R	7	0402C	CHIPCAP X5R 100N K 10V 0402	100n	10V
C353	2320805	Bottom	R	7	0402C	CHIPCAP X5R 100N K 10V 0402	100n	10V
C357	2320778	Bottom	O	5	0402C	Chipcap X7R 10% 16V 0402	10n	16V
C358	2320778	Bottom	O	5	0402C	Chipcap X7R 10% 16V 0402	10n	16V
C359	2320805	Bottom	M	6	0402C	CHIPCAP X5R 100N K 10V 0402	100n	10V
C361	2320584	Bottom	N	7	0402C	Chipcap 5% X7R	1n0	50V
C362	2320778	Bottom	P	5	0402C	Chipcap X7R 10% 16V 0402	10n	16V
C363	2315261	Bottom	O	7	0405_2_P0.65	CHIP ARRAY X5R 2X47N K 10V 0405	2x47n	10V
C364	2320752	Bottom	M	7	0402C	Chipcap X7R 10% 50V 0402	2n2	50V
C365	2315209	Bottom	N	7	0405_2_P0.65_AVX	CHIP ARRAY X5R 2X33N M 10V 0405	2x33n	10V
C366	2320785	Bottom	O	7	0402C	chipcap x7r 47n k 10v 0402	47n	10V
C367	2320744	Bottom	P	6	0402C	Chipcap X7R 10% 50V 0402	1n0	50V
C370	2320760	Bottom	O	6	0402C	Chipcap X7R 10% 25V 0402	4n7	25V

ITEM	CODE	SIDE	X	Y	VALUE	PART NUMBER	VALUE	VALUE
C371	2320805	Bottom	O	7	0402C	CHIPCAP X5R 100N K 10V 0402	100n	10V
C372	2320481	Bottom	O	7	0603C	CHIPCAP X5R 1U K 6V3 0603	1u0	6.3V
C373	2320783	Bottom	M	7	0402C	CHIPCAP X7R 33N K 10V 0402	33n	10V
C374	2320744	Bottom	M	7	0402C	Chipcap X7R 10% 50V 0402	1n0	50V
C375	2320752	Bottom	M	7	0402C	Chipcap X7R 10% 50V 0402	2n2	50V
C376	2320481	Bottom	M	6	0603C	CHIPCAP X5R 1U K 6V3 0603	1u0	6.3V
C377	2320805	Bottom	M	6	0402C	CHIPCAP X5R 100N K 10V 0402	100n	10V
C378	2320544	Bottom	O	6	0402C	Chipcap 5% NP0	22p	50V
C379	2320552	Bottom	O	6	0402C	Chipcap 5% NP0	47p	50V
C390	2320805	Bottom	R	2	0402C	CHIPCAP X5R 100N K 10V 0402	100n	10V
C400	2320778	Top	O	3	0402C	Chipcap X7R 10% 16V 0402	10n	16V
C401	2320805	Top	O	2	0402C	CHIPCAP X5R 100N K 10V 0402	100n	10V
C402	2320778	Top	L	3	0402C	Chipcap X7R 10% 16V 0402	10n	16V
C403	2320778	Top	M	4	0402C	Chipcap X7R 10% 16V 0402	10n	16V
C404	2320778	Top	M	4	0402C	Chipcap X7R 10% 16V 0402	10n	16V
C405	2320778	Top	L	3	0402C	Chipcap X7R 10% 16V 0402	10n	16V
C420	2320560	Top	L	3	0402C	Chipcap 5% NP0	100p	50V
C421	2320560	Top	M	4	0402C	Chipcap 5% NP0	100p	50V
C422	2320560	Top	M	4	0402C	Chipcap 5% NP0	100p	50V
C450	2320778	Top	O	2	0402C	Chipcap X7R 10% 16V 0402	10n	16V
C451	2320805	Top	O	2	0402C	CHIPCAP X5R 100N K 10V 0402	100n	10V
C452	2320805	Top	S	2	0402C	CHIPCAP X5R 100N K 10V 0402	100n	10V
C454	2320779	Top	O	3	0603_BLM	CHIPCAP X7R 100N K 16V 0603	100n	16V
C500	2320598	Bottom	J	6	0402C	Chipcap 5% X7R	3n9	50V
C503	2320564	Bottom	J	2	0402C	Chipcap 5% NP0	150p	50V
C504	2322023	Bottom	J	2	0603C	CHIPCAP NP0 2N2 J 16V 0603	2n2	16V
C505	2321013	Bottom	J	2	0402C	CHIPCAP NP0 270P J 25V 0402	270p	25V
C507	2322023	Bottom	I	5	0603C	CHIPCAP NP0 2N2 J 16V 0603	2n2	16V
C511	2320560	Bottom	E	2	0402C	Chipcap 5% NP0	100p	50V
C520	2320554	Bottom	J	6	0402C	Chipcap 5% NP0	56p	50V
C522	2320604	Bottom	I	6	0402C	Chipcap 5% NP0	18p	50V
C531	2320546	Bottom	B	5	0402C	Chipcap 5% NP0	27p	50V
C532	2320604	Bottom	I	4	0402C	Chipcap 5% NP0	18p	50V
C533	2320554	Bottom	I	4	0402C	Chipcap 5% NP0	56p	50V
C535	2320552	Bottom	L	5	0402C	Chipcap 5% NP0	47p	50V
C536	2320552	Bottom	L	5	0402C	Chipcap 5% NP0	47p	50V
C537	2320560	Bottom	K	5	0402C	Chipcap 5% NP0	100p	50V
C540	2320491	Bottom	L	7	0603C	CHIPCAP X7R 220N K 10V 0603	220n	10V
C543	2320558	Bottom	I	2	0402C	Chipcap 5% NP0	82p	50V
C545	2315017	Bottom	J	3	0612_W3A4_CAF13	CHIP ARRAY NP0 4X470P J 16V 0612	4x470p	16V
C549	2320805	Bottom	K	3	0402C	CHIPCAP X5R 100N K 10V 0402	100n	10V
C550	2320620	Bottom	K	6	0402C	Chipcap X7R 5% 16V 0402	10n	16V
C551	2320546	Bottom	K	5	0402C	Chipcap 5% NP0	27p	50V
C552	2320805	Bottom	L	4	0402C	CHIPCAP X5R 100N K 10V 0402	100n	10V
C553	2320536	Bottom	L	4	0402C	Chipcap 5% NP0	10p	50V
C554	2320620	Bottom	J	3	0402C	Chipcap X7R 5% 16V 0402	10n	16V
C555	2320805	Bottom	K	3	0402C	CHIPCAP X5R 100N K 10V 0402	100n	10V
C560	2320536	Bottom	J	2	0402C	Chipcap 5% NP0	10p	50V
C568	2320907	Bottom	J	5	0402C_AVX	CHIPCAP NP0 HQ 0P7 B 16V 0402	0p7	16V
C570	2320544	Bottom	J	5	0402C	Chipcap 5% NP0	22p	50V
C575	2320536	Bottom	K	5	0402C	Chipcap 5% NP0	10p	50V
C576	2320805	Bottom	K	7	0402C	CHIPCAP X5R 100N K 10V 0402	100n	10V
C577	2320481	Bottom	J	2	0603C	CHIPCAP X5R 1U K 6V3 0603	1u0	6.3V
C703	2310045	Bottom	C	7	0402C_GRM36	CHIPCAP X5R 68N K 10V 0402	68n	10V
C704	2310045	Bottom	D	7	0402C_GRM36	CHIPCAP X5R 68N K 10V 0402	68n	10V
C705	2320546	Bottom	C	7	0402C	Chipcap 5% NP0	27p	50V
C706	2320546	Bottom	C	7	0402C	Chipcap 5% NP0	27p	50V
C707	2320518	Bottom	B	7	0402C	Chipcap +/-0.25pF NP0	1p8	50V
C709	2320540	Bottom	E	7	0402C	Chipcap 5% NP0	15p	50V

ITEM	CODE	SIDE	X	Y	VALUE	PART NUMBER	VALUE	VALUE
C710	2320540	Bottom	E	7	0402C	Chipcap 5% NP0	15p	50V
C711	2320522	Bottom	E	6	0402C	Chipcap +-0.25pF NP0	2p7	50V
C713	2320584	Bottom	C	7	0402C	Chipcap 5% X7R	1n0	50V
C714	2320584	Bottom	E	7	0402C	Chipcap 5% X7R	1n0	50V
C715	2320554	Bottom	E	5	0402C	Chipcap 5% NP0	56p	50V
C718	2320584	Bottom	B	5	0402C	Chipcap 5% X7R	1n0	50V
C723	2320540	Bottom	E	4	0402C	Chipcap 5% NP0	15p	50V
C725	2312243	Bottom	E	4	0805C	CHIPCAP X5R 4U7 K 6V3 0805	4u7	6V3
C726	2320546	Bottom	F	4	0402C	Chipcap 5% NP0	27p	50V
C727	2611745	Bottom	G	5	TANT TPSY	CHIPTCAP 150U M 10V 7.3X4.3X2.0	150u 10V	10V
C728	2320560	Bottom	D	7	0402C	Chipcap 5% NP0	100p	50V
C729	2320554	Bottom	C	4	0402C	Chipcap 5% NP0	56p	50V
C731	2320560	Bottom	E	5	0402C	Chipcap 5% NP0	100p	50V
C732	2320744	Bottom	E	5	0402C	Chipcap X7R 10% 50V 0402	1n0	50V
C804	2320560	Bottom	C	4	0402C	Chipcap 5% NP0	100p	50V
C805	2320560	Bottom	D	2	0402C	Chipcap 5% NP0	100p	50V
C807	2320560	Bottom	I	4	0402C	Chipcap 5% NP0	100p	50V
C808	2320560	Bottom	I	4	0402C	Chipcap 5% NP0	100p	50V
C826	2320522	Bottom	E	2	0402C	Chipcap +-0.25pF NP0	2p7	50V
C827	2320805	Bottom	E	2	0402C	CHIPCAP X5R 100N K 10V 0402	100n	10V
C828	2320540	Bottom	E	3	0402C	Chipcap 5% NP0	15p	50V
C829	2320516	Bottom	E	3	0402C	Chipcap +-0.25pF NP0	1p5	50V
C831	2320552	Bottom	B	4	0402C	Chipcap 5% NP0	47p	50V
C836	2320522	Bottom	C	2	0402C	Chipcap +-0.25pF NP0	2p7	50V
C837	2320522	Bottom	C	2	0402C	Chipcap +-0.25pF NP0	2p7	50V
C838	2320520	Bottom	C	2	0402C	Chipcap +-0.25pF NP0	2p2	50V
C839	2320520	Bottom	C	2	0402C	Chipcap +-0.25pF NP0	2p2	50V
D200	4370825	Top	O	5	uBGA168	UEMK 4.4 W-DOG ENA TO21 TFBGA168	~	~
D400	4370873	Top	N	2	uBGA144_CC	UPP8M V2.2 F751986B C035 UBGA144	~	~
D450	4341529	Top	P	2	TGBA48	FLASH 4MX16 1.8/1.8V TBGA48	4Mx16	~
D452	4341423	Top	R	2	uBGA48_6.1X7.1	SRAM 512KX8 1.8V TBGA48	512kx8	~
F100	5119019	Top	S	3	0603_FUSE	SM FUSE F 1.5A 32V 0603	1.5A	~
G300	4700131	Bottom	H	2	XH414_II02N	CELL CAPACITOR 0.01MAH 3V3	3V3	~
G500	4350315	Bottom	K	2	VCO_FDK_IT_H1.7	VCO 3420-3980MHZ 2.7V 19MA	3420-3980MHz	~
G501	4510349	Bottom	K	6	VCTCXO_KT20	VCTCXO 26MHZ+-10PPM 2.7V 1.5MA	26MHz	~
L100	3203743	Top	S	3	0805_BLM21	FERR.BEAD 0R03 42R/100MHZ 3A 0805	42R/100MHz	~
L101	3203725	Top	S	4	FERRITE_0402	FERRITE BEAD 0R6 600R/100M 0402	600R/100MHz	~
L102	3203803	Top	T	5	0405_2_H1.0	CHIP BEAD ARRAY 2X1000R 0405	2x1000R/100MHz	~
L103	3203803	Top	S	6	0405_2_H1.0	CHIP BEAD ARRAY 2X1000R 0405	2x1000R/100MHz	~
L104	3203803	Top	T	7	0405_2_H1.0	CHIP BEAD ARRAY 2X1000R 0405	2x1000R/100MHz	~
L105	3645011	Top	T	6	COIL_LK_1608	CHIP COIL 68NH J Q12/100MHZ 0603	68nH	~
L106	3203725	Top	T	4	FERRITE_0402	FERRITE BEAD 0R6 600R/100M 0402	600R/100MHz	~
L107	3203741	Top	S	4	0603_BLM	FERRITE BEAD 0R5 600R/100MHZ 0603	600R/100MHz	~
L108	3203725	Top	S	4	FERRITE_0402	FERRITE BEAD 0R6 600R/100M 0402	600R/100MHz	~
L150	3203803	Top	A	3	0405_2_H1.0	CHIP BEAD ARRAY 2X1000R 0405	2x1000R/100MHz	~
L151	3645209	Bottom	H	3	COIL_0603CS	CHIP COIL 33N G Q40/250MHZ 0603	33nH	~
L152	3645209	Bottom	H	3	COIL_0603CS	CHIP COIL 33N G Q40/250MHZ 0603	33nH	~
L260	3203741	Top	O	7	0603_BLM	FERRITE BEAD 0R5 600R/100MHZ 0603	600R/100MHz	~
L261	3203741	Top	O	7	0603_BLM	FERRITE BEAD 0R5 600R/100MHZ 0603	600R/100MHz	~
L262	3203741	Top	M	7	0603_BLM	FERRITE BEAD 0R5 600R/100MHZ 0603	600R/100MHz	~
L263	3203741	Top	M	5	0603_BLM	FERRITE BEAD 0R5 600R/100MHZ 0603	600R/100MHz	~
L264	3203741	Top	M	6	0603_BLM	FERRITE BEAD 0R5 600R/100MHZ 0603	600R/100MHz	~
L265	3203741	Top	Q	4	0603_BLM	FERRITE BEAD 0R5 600R/100MHZ 0603	600R/100MHz	~
L300	3640119	Bottom	I	7	CHOKE_984FB	CHOKE 22U M 1R4 0.33A 3.3X3.3X1.5	22uH	~
L307	3646027	Bottom	G	2	0402_ELJRF	CHIP COIL 33N J Q7/100MHZ 0402	33nH	~
L308	3646027	Bottom	G	3	0402_ELJRF	CHIP COIL 33N J Q7/100MHZ 0402	33nH	~
L356	3645209	Bottom	O	5	COIL_0603CS	CHIP COIL 33N G Q40/250MHZ 0603	33nH	~
L357	3645209	Bottom	N	5	COIL_0603CS	CHIP COIL 33N G Q40/250MHZ 0603	33nH	~
L358	3645161	Bottom	O	6	0603L	CHIP COIL 150N J Q14/100MHZ 0603	150nH	~

ITEM	CODE	SIDE	X	Y	VALUE	PART NUMBER	VALUE	VALUE
L386	3203725	Bottom	R	3	FERRITE_0402	FERRITE BEAD 0R6 600R/100M 0402	600R/100MHz	~
L500	3646053	Bottom	J	5	0402L	CHIP COIL 4N7 +-0N3 Q28/800M 0402	4n7H	~
L501	3646053	Bottom	J	5	0402L	CHIP COIL 4N7 +-0N3 Q28/800M 0402	4n7H	~
L700	3646069	Bottom	C	7	0402L	CHIP COIL 33N J Q23/800M 0402	33nH	~
L701	3646063	Bottom	B	7	0402L	CHIP COIL 22N J Q28/800M 0402	22nH	~
L702	3646053	Bottom	E	6	0402L	CHIP COIL 4N7 +-0N3 Q28/800M 0402	4n7H	~
L703	3203743	Bottom	E	4	0805_BLM21	FERR.BEAD 0R03 42R/100MHZ 3A 0805	42R/100MHz	~
L800	3646051	Bottom	E	2	0402L	CHIP COIL 3N9 +-0N3 Q28/800M 0402	3n9H	~
L805	3646009	Bottom	I	4	0402L	CHIP COIL 10N J Q30/800M 0402	10nH	~
L809	3646065	Bottom	I	3	0402L	CHIP COIL 12N J Q31/800M 0402	12nH	~
L810	3646065	Bottom	I	3	0402L	CHIP COIL 12N J Q31/800M 0402	12nH	~
L821	3646059	Bottom	C	2	0402L	CHIP COIL 5N6 +-0N3 Q28/800M 0402	5n6H	~
L824	3646047	Bottom	E	2	0402L	CHIP COIL 3N3 +-0N3 Q28/800M 0402	3n3H	~
M300	6800055	Bottom	G	2	VIBRA_M_KHN5NB1X	VIB MOTOR ASSY 1.3V 105MA 8500	~	~
N100	4341063	Top	S	5	SOT23_5_H1.2	REG 2.8V/150MA LP3985 SOT23-5	~	2.8V
N150	4341345	Top	R	6	USMD_18	AF AMP /(LM4855BLA18AAB) USMD18	~	~
N300	4341309	Bottom	I	7	SOT23L_8	DC/DC CONV 350MA TK11851 SSOP8	~	~
N350	486C004	Bottom	R	7	IRDA_CIM_50M5_T2	IRDA CIM-50M5 1.152MB >2.4V 8PIN	~	~
N356	4341427	Bottom	N	6	HVQFN40	FM RECEIVER TEA5767HN LQFP40	~	~
N500	4370895	Bottom	J	4	uBGA_108_P0.5	HLGA618A TFA3F TFBGA108	~	~
N700	4350383	Bottom	D	5	PW_AMP_RF9219_E1	PWAMP RF9219E2.X 900/1800/1900MHZ	~	~
R100	1430718	Top	R	5	0402R	Resistor 5% 63mW	47R	~
R101	1430718	Top	R	5	0402R	Resistor 5% 63mW	47R	~
R102	1430726	Top	R	5	0402R	Resistor 5% 63mW	100R	~
R103	4120011	Top	R	5	uBGA5	ZDIX4 IP4043CX5 CA 14V2 10W CSP5	~	~
R104	1430812	Top	R	5	0402R	Resistor 5% 63mW	220k	~
R105	1825033	Top	R	6	0402_VAR	CHIP VARISTOR VW14V VC46V 0402	14V/46V	~
R106	1825033	Top	S	6	0402_VAR	CHIP VARISTOR VW14V VC46V 0402	14V/46V	~
R107	1825033	Top	S	6	0402_VAR	CHIP VARISTOR VW14V VC46V 0402	14V/46V	~
R108	1825033	Top	S	7	0402_VAR	CHIP VARISTOR VW14V VC46V 0402	14V/46V	~
R109	1430804	Top	R	5	0402R	Resistor 5% 63mW	100k	~
R111	1430804	Top	S	4	0402R	Resistor 5% 63mW	100k	~
R115	1820039	Bottom	L	5	0402_NTH5	NTC RES 47K J B=4050+-3% 0402	47k	~
R118	1430718	Top	T	4	0402R	Resistor 5% 63mW	47R	~
R119	1430718	Top	T	5	0402R	Resistor 5% 63mW	47R	~
R151	1825033	Top	A	2	0402_VAR	CHIP VARISTOR VW14V VC46V 0402	14V/46V	~
R152	1825033	Top	A	2	0402_VAR	CHIP VARISTOR VW14V VC46V 0402	14V/46V	~
R153	1430137	Top	Q	5	0402R	CHIPRES 0W06 1K0 F 200PPM 0402	1k0	~
R154	1430137	Top	Q	5	0402R	CHIPRES 0W06 1K0 F 200PPM 0402	1k0	~
R155	1620105	Top	Q	5	MNR02	RES NETWORK 0W06 2X2k2 J 0404	2x2k2	~
R156	1430756	Top	Q	5	0402R	Resistor 5% 63mW	1k2	~
R157	1620105	Top	Q	6	MNR02	RES NETWORK 0W06 2X2k2 J 0404	2x2k2	~
R158	1825033	Top	S	5	0402_VAR	CHIP VARISTOR VW14V VC46V 0402	14V/46V	~
R159	1825033	Top	S	5	0402_VAR	CHIP VARISTOR VW14V VC46V 0402	14V/46V	~
R163	1430764	Top	R	6	0402R	Resistor 5% 63mW	3k3	~
R164	1430700	Top	R	6	0402R	Resistor 5% 63mW	10R	~
R165	1430700	Top	R	6	0402R	Resistor 5% 63mW	10R	~
R166	1430700	Top	R	6	0402R	Resistor 5% 63mW	10R	~
R167	1430700	Top	R	6	0402R	Resistor 5% 63mW	10R	~
R171	1430788	Top	Q	5	0402R	Resistor 5% 63mW	22k	~
R176	1430756	Top	Q	5	0402R	Resistor 5% 63mW	1k2	~
R200	1414605	Top	N	7	0805R	CHIPRES 0W25 0R22 J 0805	0R22	~
R202	1430145	Bottom	M	5	0402R	Chipres 0W06 100k F 200ppm 0402	100k	~
R203	1430145	Top	Q	5	0402R	Chipres 0W06 100k F 200ppm 0402	100k	~
R206	1430770	Top	P	4	0402R	Resistor 5% 63mW	4k7	~
R207	1430770	Bottom	M	5	0402R	Resistor 5% 63mW	4k7	~
R211	1430848	Top	L	7	0402R	Resistor 1% 63mW	12k	~
R212	1430215	Top	L	7	0402R	CHIPRES 0W06 68K F 200PPM 0402	68k	~
R301	1430187	Bottom	H	7	0402R	Chipres 0W06 47k F 200ppm 0402	47k	~

ITEM	CODE	SIDE	X	Y	VALUE	PART NUMBER	VALUE	VALUE
R302	1430855	Bottom	J	7	0402R	CHIPRES 0W06 300K F 200PPM 0402	300k	~
R303	1430121	Bottom	J	7	0402R	Chipres 0W06 22k F 200ppm 0402	22k	~
R306	1430778	Bottom	A	5	0402R	Resistor 5% 63mW	10k	~
R307	1825033	Top	L	4	0402_VAR	CHIP VARISTOR VW14V VC46V 0402	14V/46V	~
R308	1430740	Bottom	B	5	0402R	Resistor 5% 63mW	330R	~
R309	1430740	Bottom	A	5	0402R	Resistor 5% 63mW	330R	~
R311	1430249	Top	L	7	0402R	CHIPRES 0W06 33R F 100PPM 0402	33R	~
R312	1430774	Top	M	7	0402R	Resistor 5% 63mW	6k8	~
R313	1430716	Top	L	4	0402R	Resistor 5% 63mW	39R	~
R314	1430774	Top	L	4	0402R	Resistor 5% 63mW	6k8	~
R315	1430712	Top	A	3	0402R	Resistor 5% 63mW	27R	~
R316	1430770	Top	B	2	0402R	Resistor 5% 63mW	4k7	~
R325	1430691	Bottom	I	7	0402R	CHIPRES 0W06 2R2 J 0402	2R2	~
R350	1413850	Bottom	Q	6	0805R	CHIPRES 0W125 4R7 J 0805	4R7	~
R357	1430792	Bottom	M	6	0402R	Resistor 5% 63mW	33k	~
R358	1430718	Bottom	P	6	0402R	Resistor 5% 63mW	47R	~
R359	1430778	Bottom	O	6	0402R	Resistor 5% 63mW	10k	~
R360	1430804	Bottom	O	6	0402R	Resistor 5% 63mW	100k	~
R361	1430788	Bottom	M	6	0402R	Resistor 5% 63mW	22k	~
R362	1430702	Bottom	M	6	0402R	Resistor 5% 63mW	12R	~
R364	1430700	Bottom	M	6	0402R	Resistor 5% 63mW	10R	~
R367	1430786	Bottom	O	7	0402R	Resistor 5% 63mW	18k	~
R368	1430700	Bottom	O	6	0402R	Resistor 5% 63mW	10R	~
R369	1430792	Bottom	M	7	0402R	Resistor 5% 63mW	33k	~
R372	1430788	Bottom	N	5	0402R	Resistor 5% 63mW	22k	~
R388	4120071	Bottom	Q	5	uBGA8	ASIP EMIF03-SIM01 SIM FILTER BGA8	~	~
R420	1430726	Top	L	3	0402R	Resistor 5% 63mW	100R	~
R421	1430778	Top	M	4	0402R	Resistor 5% 63mW	10k	~
R422	1430873	Top	M	5	0402R	CHIPRES 0W06 27K F 0402	27k	~
R423	1430778	Top	M	4	0402R	Resistor 5% 63mW	10k	~
R450	1430770	Top	O	3	0402R	Resistor 5% 63mW	4k7	~
R500	1430693	Bottom	J	2	0402R	Chipres 0W06 5R6 J 0402	5R6	~
R501	1430754	Bottom	J	1	0402R	Resistor 5% 63mW	1k0	~
R502	1430337	Bottom	J	1	0603R	CHIPRES 0W06 9K1 F 0603	9k1	~
R503	1430770	Bottom	I	5	0402R	Resistor 5% 63mW	4k7	~
R504	1430788	Bottom	I	5	0402R	Resistor 5% 63mW	22k	~
R516	1620033	Bottom	L	5	0404_R	RES NETWORK 0W06 2X5K6 J 0404	2x5k6	~
R517	1620033	Bottom	L	5	0404_R	RES NETWORK 0W06 2X5K6 J 0404	2x5k6	~
R520	1430774	Bottom	L	7	0402R	Resistor 5% 63mW	6k8	~
R522	1430784	Bottom	I	2	0402R	Resistor 5% 63mW	15k	~
R523	1430865	Bottom	K	3	0402R	CHIPRES 0W06 5K6 F 0402	5k6	~
R525	1430770	Bottom	K	3	0402R	Resistor 5% 63mW	4k7	~
R540	1430754	Bottom	I	3	0402R	Resistor 5% 63mW	1k0	~
R702	1430690	Bottom	D	4	0402R	Chipres 0W06 jumper 0402	0R	~
R703	1430714	Bottom	D	7	0402R	Resistor 5% 63mW	33R	~
R704	1430714	Bottom	E	7	0402R	Resistor 5% 63mW	33R	~
R706	1430681	Bottom	B	7	0402R	CHIPRES 0W06 4R3 J 0402	4R3	~
R709	1430754	Bottom	D	3	0402R	Resistor 5% 63mW	1k0	~
R710	1430766	Bottom	D	3	0402R	Resistor 5% 63mW	3k9	~
R713	1430691	Bottom	C	7	0402R	CHIPRES 0W06 2R2 J 0402	2R2	~
R750	1430690	Bottom	E	6	0402R	Chipres 0W06 jumper 0402	0R	~
R800	1430700	Bottom	E	3	0402R	Resistor 5% 63mW	10R	~
R801	1430726	Bottom	E	3	0402R	Resistor 5% 63mW	100R	~
R808	1620031	Bottom	D	2	0404_R_SR	RES NETWORK 0W06 2X1K0 J 0404	2x1k0	~
S300	5200025	Bottom	C	1	SWITCH_SKRE	SM TACT SW SIDE TRAVEL 0.2MM	~	~
S301	5200025	Bottom	E	1	SWITCH_SKRE	SM TACT SW SIDE TRAVEL 0.2MM	~	~
S302	5200025	Bottom	A	6	SWITCH_SKRE	SM TACT SW SIDE TRAVEL 0.2MM	~	~
T500	3640423	Bottom	L	3	TRANS_LDB15	BALUN TRANS 3.7GHZ+/-300MHZ 0805	~	~
T700	4550223	Bottom	E	7	TRANS_LDB15	TRANSF BALUN 1800+-100mhz 2x1.25	~	~

ITEM	CODE	SIDE	X	Y	VALUE	PART NUMBER	VALUE	VALUE
T802	3640431	Bottom	E	3	EHF_FD1774	TRANSF BALUN 1920+/-70MHZ 0805	~	~
V100	4113721	Top	R	3	CASE_457	TVS DI 1PMT16AT3 16V 175W PWRMITE	~	~
V300	4110475	Bottom	H	7	EMD2	SCH DI RB521S-30 200MA 35V SOD523	~	~
V311	4219937	Top	M	7	SOT_363	TRX2 UMT1/PUMT1 P40V100MA SOT363	~	~
V312	4219921	Top	M	7	EM3	TR DTC143ZE N RBE4K7/47K 0A1 SC75	~	~
V313	4219937	Top	L	4	SOT_363	TRX2 UMT1/PUMT1 P40V100MA SOT363	~	~
V314	4219921	Top	L	3	EM3	TR DTC143ZE N RBE4K7/47K 0A1 SC75	~	~
V317	4219937	Top	B	2	SOT_363	TRX2 UMT1/PUMT1 P40V100MA SOT363	~	~
V318	486B012	Bottom	A	3	LED_SMD2_R	LED ZW Y87C-S2T2-35-0-20	~	~
V319	4860315	Bottom	A	3	LED_LWY87C	LED LWY87C-S2T2-1 >224 WHITE SMD2	~	~
V320	4219921	Top	L	4	EM3	TR DTC143ZE N RBE4K7/47K 0A1 SC75	~	~
V356	4110965	Bottom	O	5	SOD_523	CAP.DI BB202 CT=2.5 FM 0R8 SOD523	~	~
V357	4110965	Bottom	N	5	SOD_523	CAP.DI BB202 CT=2.5 FM 0R8 SOD523	~	~
V801	4219903	Bottom	C	2	SOT_363	TRX2 BFM505 N 20V 18MA 9GHZ SOT363	~	~
V802	4210261	Bottom	E	2	SOT_363	TR BGA428 LNA1.8GHZ 19.5DB SOT363	~	~
X100	5409253	Bottom	G	6	LYNX_BATT_CONN	SM BATTERY CONN 3POL SPR 12V 2A	~	~
X301	5469135	Top	L	6	CPBT_297884_6	SM CONN 2X8 SPR 50V 0.5A PCB/PCB	~	~
X302	5469175	Top	B	6	CON_DF23C_10DS	SM CONN BTB 2X5 F P0.5	~	~
X386	5400085	Bottom	O	3	SIM_READER_HD940	SIM CARD READER 2X3POL P2.54 SM	~	~
Z300	4120031	Top	L	5	uBGA24	EMI/ESD FILT EMIF10-1K010F1 BGA24	~	~
Z700	4511337	Bottom	C	7	DCC6D_H1.225	SAW FILT 897.5+-17.5MHZ/2.6DB 3X3	897.5MHz	~
Z800	4550241	Bottom	C	3	ANT_SW_LMZ0135_8C	ANT.SW+2SAW 880-960/1710-1990 MHZ	~	~
Z806	4511339	Bottom	D	2	DCS4D_H1.0	SAW FILT 1960+-30MHZ/2.7DB 2X2.5	1960MHz	~

Parts list NPM-6X

ITEM	CODE	SIDE	X	Y	VALUE	PART NAME	VALUE	VALUE
A1	9517174	Bottom	O	6	SHIELD_DMC01304	NECTAR SHIELD ASSY DMC04525 NHL-4	~	~
A2	9458467	Bottom	J	4	SHIELD_DMC04970	SHIELDING CAN RF ASSY DMC04970-EN	~	~
A3	9517151	Bottom	D	5	SHIELD_DMC04061	HELGA SHIELD ASSY DMC04061 NHL-4	~	~
B200	4510219	Top	Q	6	CRYSTAL_CX_4V	CRYSTAL 32.768KHZ+-30PPM 9PF	32.768kHz	~
B300	5140247	Top	A	4	SPEAKER_WD2039832	SPEAKER 105+-3DB 32R D8X3MM PICO	~	~
C100	2320546	Bottom	H	7	0402C	Chipcap 5% NP0	27p	50V
C101	2320481	Top	S	4	0603C	CHIPCAP X5R 1U K 6V3 0603	1u0	6.3V
C102	2320481	Top	R	5	0603C	CHIPCAP X5R 1U K 6V3 0603	1u0	6.3V
C103	2321013	Top	R	5	0402C	CHIPCAP NP0 270P J 25V 0402	270p	25V
C104	2315201	Top	R	5	0405_2_P0.65	CHIP ARRAY NP0 2X27P K 25V 0405	2x27p	25V
C106	2320744	Top	R	4	0402C	Chipcap X7R 10% 50V 0402	1n0	50V
C107	2320536	Top	S	6	0402C	Chipcap 5% NP0	10p	50V
C108	2320536	Top	S	6	0402C	Chipcap 5% NP0	10p	50V
C109	2320536	Top	T	6	0402C	Chipcap 5% NP0	10p	50V
C110	2320544	Top	R	4	0402C	Chipcap 5% NP0	22p	50V
C112	2320778	Top	S	5	0402C	Chipcap X7R 10% 16V 0402	10n	16V
C113	2320756	Top	S	6	0402C	Chipcap X7R 10% 50V 0402	3n3	50V
C114	2320756	Top	S	6	0402C	Chipcap X7R 10% 50V 0402	3n3	50V
C115	2320756	Top	T	5	0402C	Chipcap X7R 10% 50V 0402	3n3	50V
C116	2320756	Top	T	5	0402C	Chipcap X7R 10% 50V 0402	3n3	50V
C117	2320536	Top	T	6	0402C	Chipcap 5% NP0	10p	50V
C118	2320756	Top	S	7	0402C	Chipcap X7R 10% 50V 0402	3n3	50V
C119	2320756	Top	S	6	0402C	Chipcap X7R 10% 50V 0402	3n3	50V
C150	2320805	Top	P	5	0402C	CHIPCAP X5R 100N K 10V 0402	100n	10V
C151	2315205	Top	Q	6	0405_2_P0.65_AVX	CHIP ARRAY X5R 2X1N M 16V 0405	2x1n	16V
C152	2320805	Top	P	5	0402C	CHIPCAP X5R 100N K 10V 0402	100n	10V
C153	2315209	Top	P	6	0405_2_P0.65_AVX	CHIP ARRAY X5R 2X33N M 10V 0405	2x33n	10V
C154	2315209	Top	P	5	0405_2_P0.65_AVX	CHIP ARRAY X5R 2X33N M 10V 0405	2x33n	10V
C155	2315201	Top	A	2	0405_2_P0.65	CHIP ARRAY NP0 2X27P K 25V 0405	2x27p	25V
C156	2315205	Top	Q	5	0405_2_P0.65_AVX	CHIP ARRAY X5R 2X1N M 16V 0405	2x1n	16V
C157	2315201	Top	R	6	0405_2_P0.65	CHIP ARRAY NP0 2X27P K 25V 0405	2x27p	25V
C158	2315201	Top	R	6	0405_2_P0.65	CHIP ARRAY NP0 2X27P K 25V 0405	2x27p	25V
C159	2315201	Top	S	5	0405_2_P0.65	CHIP ARRAY NP0 2X27P K 25V 0405	2x27p	25V
C160	2320805	Top	Q	7	0402C	CHIPCAP X5R 100N K 10V 0402	100n	10V
C161	2320805	Top	R	7	0402C	CHIPCAP X5R 100N K 10V 0402	100n	10V
C162	2320805	Top	Q	6	0402C	CHIPCAP X5R 100N K 10V 0402	100n	10V
C163	2320805	Top	R	7	0402C	CHIPCAP X5R 100N K 10V 0402	100n	10V
C165	2320805	Bottom	N	7	0402C	CHIPCAP X5R 100N K 10V 0402	100n	10V
C166	2320481	Top	Q	7	0603C	CHIPCAP X5R 1U K 6V3 0603	1u0	6.3V
C167	2320481	Top	R	7	0603C	CHIPCAP X5R 1U K 6V3 0603	1u0	6.3V
C168	2320805	Bottom	P	5	0402C	CHIPCAP X5R 100N K 10V 0402	100n	10V
C169	2320805	Top	R	6	0402C	CHIPCAP X5R 100N K 10V 0402	100n	10V
C170	2320544	Bottom	D	1	0402C	Chipcap 5% NP0	22p	50V
C171	2320544	Bottom	E	1	0402C	Chipcap 5% NP0	22p	50V
C172	2320544	Bottom	C	1	0402C	Chipcap 5% NP0	22p	50V
C173	2320538	Top	Q	6	0402C	Chipcap 5% NP0	12p	50V
C174	2320538	Top	Q	6	0402C	Chipcap 5% NP0	12p	50V
C175	2320538	Top	Q	6	0402C	Chipcap 5% NP0	12p	50V
C177	2320805	Top	Q	5	0402C	CHIPCAP X5R 100N K 10V 0402	100n	10V
C200	2320805	Top	N	7	0402C	CHIPCAP X5R 100N K 10V 0402	100n	10V
C201	2320481	Top	M	7	0603C	CHIPCAP X5R 1U K 6V3 0603	1u0	6.3V
C202	2320778	Top	M	7	0402C	Chipcap X7R 10% 16V 0402	10n	16V
C203	2320481	Top	P	4	0603C	CHIPCAP X5R 1U K 6V3 0603	1u0	6.3V
C204	2320481	Top	O	6	0603C	CHIPCAP X5R 1U K 6V3 0603	1u0	6.3V
C205	2320481	Top	O	6	0603C	CHIPCAP X5R 1U K 6V3 0603	1u0	6.3V
C206	2320481	Top	O	6	0603C	CHIPCAP X5R 1U K 6V3 0603	1u0	6.3V
C207	2320481	Top	Q	4	0603C	CHIPCAP X5R 1U K 6V3 0603	1u0	6.3V
C208	2320481	Top	M	6	0603C	CHIPCAP X5R 1U K 6V3 0603	1u0	6.3V
C209	2320536	Top	P	6	0402C	Chipcap 5% NP0	10p	50V

ITEM	CODE	SIDE	X	Y	VALUE	PART NAME	VALUE	VALUE
C210	2320536	Top	P	6	0402C	Chipcap 5% NP0	10p	50V
C211	2320481	Top	P	6	0603C	CHIPCAP X5R 1U K 6V3 0603	1u0	6.3V
C212	2320481	Top	P	6	0603C	CHIPCAP X5R 1U K 6V3 0603	1u0	6.3V
C213	2320481	Top	P	7	0603C	CHIPCAP X5R 1U K 6V3 0603	1u0	6.3V
C214	2320481	Top	P	7	0603C	CHIPCAP X5R 1U K 6V3 0603	1u0	6.3V
C215	2320481	Top	Q	5	0603C	CHIPCAP X5R 1U K 6V3 0603	1u0	6.3V
C218	2320805	Top	O	4	0402C	CHIPCAP X5R 100N K 10V 0402	100n	10V
C219	2320125	Top	M	6	0603C	CHIPCAP X5R 1U K 16V 0603	1u0	16V
C220	2320778	Bottom	M	5	0402C	Chipcap X7R 10% 16V 0402	10n	16V
C221	2320481	Top	M	6	0603C	CHIPCAP X5R 1U K 6V3 0603	1u0	6.3V
C222	2320481	Top	L	5	0603C	CHIPCAP X5R 1U K 6V3 0603	1u0	6.3V
C223	2320481	Top	L	6	0603C	CHIPCAP X5R 1U K 6V3 0603	1u0	6.3V
C224	2320481	Top	M	5	0603C	CHIPCAP X5R 1U K 6V3 0603	1u0	6.3V
C225	2320481	Top	M	6	0603C	CHIPCAP X5R 1U K 6V3 0603	1u0	6.3V
C226	2320481	Top	M	4	0603C	CHIPCAP X5R 1U K 6V3 0603	1u0	6.3V
C227	2320481	Top	L	5	0603C	CHIPCAP X5R 1U K 6V3 0603	1u0	6.3V
C228	2320481	Top	M	4	0603C	CHIPCAP X5R 1U K 6V3 0603	1u0	6.3V
C229	2320481	Top	M	4	0603C	CHIPCAP X5R 1U K 6V3 0603	1u0	6.3V
C230	2320481	Top	M	5	0603C	CHIPCAP X5R 1U K 6V3 0603	1u0	6.3V
C231	2320481	Top	M	5	0603C	CHIPCAP X5R 1U K 6V3 0603	1u0	6.3V
C232	2320481	Top	M	5	0603C	CHIPCAP X5R 1U K 6V3 0603	1u0	6.3V
C233	2320481	Top	L	6	0603C	CHIPCAP X5R 1U K 6V3 0603	1u0	6.3V
C234	2320481	Top	M	5	0603C	CHIPCAP X5R 1U K 6V3 0603	1u0	6.3V
C235	2320481	Top	P	7	0603C	CHIPCAP X5R 1U K 6V3 0603	1u0	6.3V
C236	2320805	Top	M	4	0402C	CHIPCAP X5R 100N K 10V 0402	100n	10V
C237	2320805	Top	M	4	0402C	CHIPCAP X5R 100N K 10V 0402	100n	10V
C238	2320805	Top	N	6	0402C	CHIPCAP X5R 100N K 10V 0402	100n	10V
C239	2320805	Top	P	4	0402C	CHIPCAP X5R 100N K 10V 0402	100n	10V
C240	2320778	Top	P	4	0402C	Chipcap X7R 10% 16V 0402	10n	16V
C241	2320744	Top	Q	4	0402C	Chipcap X7R 10% 50V 0402	1n0	50V
C243	2320481	Top	Q	5	0603C	CHIPCAP X5R 1U K 6V3 0603	1u0	6.3V
C245	2320778	Top	L	7	0402C	Chipcap X7R 10% 16V 0402	10n	16V
C246	2320778	Top	L	7	0402C	Chipcap X7R 10% 16V 0402	10n	16V
C260	2320481	Top	O	7	0603C	CHIPCAP X5R 1U K 6V3 0603	1u0	6.3V
C261	2320481	Top	O	7	0603C	CHIPCAP X5R 1U K 6V3 0603	1u0	6.3V
C262	2320481	Top	M	6	0603C	CHIPCAP X5R 1U K 6V3 0603	1u0	6.3V
C263	2320481	Top	M	5	0603C	CHIPCAP X5R 1U K 6V3 0603	1u0	6.3V
C264	2320481	Top	M	6	0603C	CHIPCAP X5R 1U K 6V3 0603	1u0	6.3V
C265	2320481	Top	Q	4	0603C	CHIPCAP X5R 1U K 6V3 0603	1u0	6.3V
C302	2320556	Bottom	J	7	0402C	Chipcap 5% NP0	68p	50V
C303	2320481	Bottom	I	6	0603C	CHIPCAP X5R 1U K 6V3 0603	1u0	6.3V
C304	2312249	Bottom	H	7	0805C	CHIPCAP X5R 4U7 K 10V 0805	4u7	10V
C307	2320536	Bottom	H	3	0402C	Chipcap 5% NP0	10p	50V
C308	2320536	Bottom	H	3	0402C	Chipcap 5% NP0	10p	50V
C310	2320544	Bottom	A	5	0402C	Chipcap 5% NP0	22p	50V
C350	2312243	Bottom	Q	6	0805C	CHIPCAP X5R 4U7 K 6V3 0805	4u7	6V3
C352	2320805	Bottom	R	7	0402C	CHIPCAP X5R 100N K 10V 0402	100n	10V
C353	2320805	Bottom	R	7	0402C	CHIPCAP X5R 100N K 10V 0402	100n	10V
C357	2320778	Bottom	O	5	0402C	Chipcap X7R 10% 16V 0402	10n	16V
C358	2320778	Bottom	O	5	0402C	Chipcap X7R 10% 16V 0402	10n	16V
C359	2320805	Bottom	M	6	0402C	CHIPCAP X5R 100N K 10V 0402	100n	10V
C361	2320584	Bottom	N	7	0402C	Chipcap 5% X7R	1n0	50V
C362	2320778	Bottom	P	5	0402C	Chipcap X7R 10% 16V 0402	10n	16V
C363	2315261	Bottom	O	7	0405 2 P0.65	CHIP ARRAY X5R 2X47N K 10V 0405	2x47n	10V
C364	2320752	Bottom	M	7	0402C	Chipcap X7R 10% 50V 0402	2n2	50V
C365	2315209	Bottom	N	7	0405 2 P0.65_AVX	CHIP ARRAY X5R 2X33N M 10V 0405	2x33n	10V
C366	2320785	Bottom	O	7	0402C	chipcap x7r 47n k 10v 0402	47n	10V
C367	2320744	Bottom	P	6	0402C	Chipcap X7R 10% 50V 0402	1n0	50V
C370	2320760	Bottom	O	6	0402C	Chipcap X7R 10% 25V 0402	4n7	25V

ITEM	CODE	SIDE	X	Y	VALUE	PART NAME	VALUE	VALUE
C371	2320805	Bottom	O	7	0402C	CHIPCAP X5R 100N K 10V 0402	100n	10V
C372	2320481	Bottom	O	7	0603C	CHIPCAP X5R 1U K 6V3 0603	1u0	6.3V
C373	2320783	Bottom	M	7	0402C	CHIPCAP X7R 33N K 10V 0402	33n	10V
C374	2320744	Bottom	M	7	0402C	Chipcap X7R 10% 50V 0402	1n0	50V
C375	2320752	Bottom	M	7	0402C	Chipcap X7R 10% 50V 0402	2n2	50V
C376	2320481	Bottom	M	6	0603C	CHIPCAP X5R 1U K 6V3 0603	1u0	6.3V
C377	2320805	Bottom	M	6	0402C	CHIPCAP X5R 100N K 10V 0402	100n	10V
C378	2320544	Bottom	O	6	0402C	Chipcap 5% NP0	22p	50V
C379	2320552	Bottom	O	6	0402C	Chipcap 5% NP0	47p	50V
C390	2320805	Bottom	R	2	0402C	CHIPCAP X5R 100N K 10V 0402	100n	10V
C400	2320778	Top	O	3	0402C	Chipcap X7R 10% 16V 0402	10n	16V
C401	2320805	Top	O	2	0402C	CHIPCAP X5R 100N K 10V 0402	100n	10V
C402	2320778	Top	L	3	0402C	Chipcap X7R 10% 16V 0402	10n	16V
C403	2320778	Top	M	4	0402C	Chipcap X7R 10% 16V 0402	10n	16V
C404	2320778	Top	M	4	0402C	Chipcap X7R 10% 16V 0402	10n	16V
C405	2320778	Top	L	3	0402C	Chipcap X7R 10% 16V 0402	10n	16V
C420	2320560	Top	L	3	0402C	Chipcap 5% NP0	100p	50V
C421	2320560	Top	M	4	0402C	Chipcap 5% NP0	100p	50V
C422	2320560	Top	M	4	0402C	Chipcap 5% NP0	100p	50V
C450	2320778	Top	O	2	0402C	Chipcap X7R 10% 16V 0402	10n	16V
C451	2320805	Top	O	2	0402C	CHIPCAP X5R 100N K 10V 0402	100n	10V
C452	2320805	Top	S	2	0402C	CHIPCAP X5R 100N K 10V 0402	100n	10V
C454	2320779	Top	O	3	0603_BLM	CHIPCAP X7R 100N K 16V 0603	100n	16V
C500	2320598	Bottom	J	6	0402C	Chipcap 5% X7R	3n9	50V
C503	2320564	Bottom	J	2	0402C	Chipcap 5% NP0	150p	50V
C504	2322023	Bottom	J	2	0603C	CHIPCAP NP0 2N2 J 16V 0603	2n2	16V
C505	2321013	Bottom	J	2	0402C	CHIPCAP NP0 270P J 25V 0402	270p	25V
C507	2322023	Bottom	I	5	0603C	CHIPCAP NP0 2N2 J 16V 0603	2n2	16V
C511	2320560	Bottom	E	2	0402C	Chipcap 5% NP0	100p	50V
C520	2320554	Bottom	J	6	0402C	Chipcap 5% NP0	56p	50V
C522	2320604	Bottom	I	6	0402C	Chipcap 5% NP0	18p	50V
C531	2320546	Bottom	B	5	0402C	Chipcap 5% NP0	27p	50V
C532	2320604	Bottom	I	4	0402C	Chipcap 5% NP0	18p	50V
C533	2320554	Bottom	I	4	0402C	Chipcap 5% NP0	56p	50V
C535	2320552	Bottom	L	5	0402C	Chipcap 5% NP0	47p	50V
C536	2320552	Bottom	L	5	0402C	Chipcap 5% NP0	47p	50V
C537	2320560	Bottom	K	5	0402C	Chipcap 5% NP0	100p	50V
C540	2320491	Bottom	L	7	0603C	CHIPCAP X7R 220N K 10V 0603	220n	10V
C543	2320558	Bottom	I	2	0402C	Chipcap 5% NP0	82p	50V
C545	2315017	Bottom	J	3	0612_W3A4_CAF13	CHIP ARRAY NP0 4X470P J 16V 0612	4x470p	16V
C549	2320805	Bottom	K	3	0402C	CHIPCAP X5R 100N K 10V 0402	100n	10V
C550	2320620	Bottom	K	6	0402C	Chipcap X7R 5% 16V 0402	10n	16V
C551	2320546	Bottom	K	5	0402C	Chipcap 5% NP0	27p	50V
C552	2320805	Bottom	L	4	0402C	CHIPCAP X5R 100N K 10V 0402	100n	10V
C553	2320536	Bottom	L	4	0402C	Chipcap 5% NP0	10p	50V
C554	2320620	Bottom	J	3	0402C	Chipcap X7R 5% 16V 0402	10n	16V
C555	2320805	Bottom	K	3	0402C	CHIPCAP X5R 100N K 10V 0402	100n	10V
C560	2320536	Bottom	J	2	0402C	Chipcap 5% NP0	10p	50V
C568	2320907	Bottom	J	5	0402C_AVX	CHIPCAP NP0 HQ 0P7 B 16V 0402	0p7	16V
C570	2320544	Bottom	J	5	0402C	Chipcap 5% NP0	22p	50V
C575	2320536	Bottom	K	5	0402C	Chipcap 5% NP0	10p	50V
C576	2320805	Bottom	K	7	0402C	CHIPCAP X5R 100N K 10V 0402	100n	10V
C577	2320481	Bottom	J	2	0603C	CHIPCAP X5R 1U K 6V3 0603	1u0	6.3V
C703	2310045	Bottom	C	7	0402C GRM36	CHIPCAP X5R 68N K 10V 0402	68n	10V
C704	2310045	Bottom	D	7	0402C GRM36	CHIPCAP X5R 68N K 10V 0402	68n	10V
C705	2320546	Bottom	C	7	0402C	Chipcap 5% NP0	27p	50V
C706	2320546	Bottom	C	7	0402C	Chipcap 5% NP0	27p	50V
C707	2320518	Bottom	B	7	0402C	Chipcap +-0.25pF NP0	1p8	50V
C709	2320540	Bottom	E	7	0402C	Chipcap 5% NP0	15p	50V

ITEM	CODE	SIDE	X	Y	VALUE	PART NAME	VALUE	VALUE
C710	2320540	Bottom	E	7	0402C	Chipcap 5% NP0	15p	50V
C711	2320522	Bottom	E	6	0402C	Chipcap +-0.25pF NP0	2p7	50V
C713	2320584	Bottom	C	7	0402C	Chipcap 5% X7R	1n0	50V
C714	2320584	Bottom	E	7	0402C	Chipcap 5% X7R	1n0	50V
C715	2320554	Bottom	E	5	0402C	Chipcap 5% NP0	56p	50V
C718	2320584	Bottom	B	5	0402C	Chipcap 5% X7R	1n0	50V
C723	2320540	Bottom	E	4	0402C	Chipcap 5% NP0	15p	50V
C725	2312243	Bottom	E	4	0805C	CHIPCAP X5R 4U7 K 6V3 0805	4u7	6V3
C726	2320546	Bottom	F	4	0402C	Chipcap 5% NP0	27p	50V
C727	2611745	Bottom	G	5	TANT_TPSY	CHIPTCAP 150U M 10V 7.3X4.3X2.0	150u_10V	10V
C728	2320560	Bottom	D	7	0402C	Chipcap 5% NP0	100p	50V
C729	2320554	Bottom	C	4	0402C	Chipcap 5% NP0	56p	50V
C731	2320560	Bottom	E	5	0402C	Chipcap 5% NP0	100p	50V
C732	2320744	Bottom	E	5	0402C	Chipcap X7R 10% 50V 0402	1n0	50V
C804	2320560	Bottom	C	4	0402C	Chipcap 5% NP0	100p	50V
C805	2320560	Bottom	D	2	0402C	Chipcap 5% NP0	100p	50V
C807	2320560	Bottom	I	4	0402C	Chipcap 5% NP0	100p	50V
C808	2320560	Bottom	I	4	0402C	Chipcap 5% NP0	100p	50V
C826	2320522	Bottom	E	2	0402C	Chipcap +-0.25pF NP0	2p7	50V
C827	2320805	Bottom	E	2	0402C	CHIPCAP X5R 100N K 10V 0402	100n	10V
C828	2320540	Bottom	E	3	0402C	Chipcap 5% NP0	15p	50V
C829	2320516	Bottom	E	3	0402C	Chipcap +-0.25pF NP0	1p5	50V
C831	2320552	Bottom	B	4	0402C	Chipcap 5% NP0	47p	50V
C836	2320522	Bottom	C	2	0402C	Chipcap +-0.25pF NP0	2p7	50V
C837	2320522	Bottom	C	2	0402C	Chipcap +-0.25pF NP0	2p7	50V
C838	2320520	Bottom	C	2	0402C	Chipcap +-0.25pF NP0	2p2	50V
C839	2320520	Bottom	C	2	0402C	Chipcap +-0.25pF NP0	2p2	50V
D200	4370825	Top	O	5	uBGA168	UEMK 4.4 W-DOG ENA TO21 TFBGA168	~	~
D400	4370873	Top	N	2	uBGA144_CC	UPP8M V2.2 F751986B C035 UBGA144	~	~
D450	4341531	Top	P	2	TBGA48	COMBO 64M NOR + 4M SRAM TBGA48	8Mx16	~
F100	5119019	Top	S	3	0603_FUSE	SM FUSE F 1.5A 32V 0603	1.5A	~
G300	4700131	Bottom	H	2	XH414_I102N	CELL CAPACITOR 0.01MAH 3V3	3V3	~
G500	4350315	Bottom	K	2	VCO_FDK_IT_H1.7	VCO 3420-3980MHZ 2.7V 19MA	3420-3980MHz	~
G501	4510349	Bottom	K	6	VCTCXO_KT20	VCTCXO 26MHZ+-10PPM 2.7V 1.5MA	26MHz	~
L100	3203743	Top	S	3	0805_BLM21	FERR.BEAD 0R03 42R/100MHZ 3A 0805	42R/100MHz	~
L101	3203725	Top	S	4	FERRITE_0402	FERRITE BEAD 0R6 600R/100M 0402	600R/100MHz	~
L102	3203803	Top	T	5	0405_2_H1.0	CHIP BEAD ARRAY 2X1000R 0405	2x1000R/100MHz	~
L103	3203803	Top	S	6	0405_2_H1.0	CHIP BEAD ARRAY 2X1000R 0405	2x1000R/100MHz	~
L104	3203803	Top	T	7	0405_2_H1.0	CHIP BEAD ARRAY 2X1000R 0405	2x1000R/100MHz	~
L105	3645011	Top	T	6	COIL_LK_1608	CHIP COIL 68NH J Q12/100MHZ 0603	68nH	~
L106	3203725	Top	T	4	FERRITE_0402	FERRITE BEAD 0R6 600R/100M 0402	600R/100MHz	~
L107	3203741	Top	S	4	0603_BLM	FERRITE BEAD 0R5 600R/100MHZ 0603	600R/100MHz	~
L108	3203725	Top	S	4	FERRITE_0402	FERRITE BEAD 0R6 600R/100M 0402	600R/100MHz	~
L150	3203803	Top	A	3	0405_2_H1.0	CHIP BEAD ARRAY 2X1000R 0405	2x1000R/100MHz	~
L151	3645209	Bottom	H	3	COIL_0603CS	CHIP COIL 33N G Q40/250MHZ 0603	33nH	~
L152	3645209	Bottom	H	3	COIL_0603CS	CHIP COIL 33N G Q40/250MHZ 0603	33nH	~
L260	3203741	Top	O	7	0603_BLM	FERRITE BEAD 0R5 600R/100MHZ 0603	600R/100MHz	~
L261	3203741	Top	O	7	0603_BLM	FERRITE BEAD 0R5 600R/100MHZ 0603	600R/100MHz	~
L262	3203741	Top	M	7	0603_BLM	FERRITE BEAD 0R5 600R/100MHZ 0603	600R/100MHz	~
L263	3203741	Top	M	5	0603_BLM	FERRITE BEAD 0R5 600R/100MHZ 0603	600R/100MHz	~
L264	3203741	Top	M	6	0603_BLM	FERRITE BEAD 0R5 600R/100MHZ 0603	600R/100MHz	~
L265	3203741	Top	Q	4	0603_BLM	FERRITE BEAD 0R5 600R/100MHZ 0603	600R/100MHz	~
L300	3640119	Bottom	I	7	CHOKE_984FB	CHOKE 22U M 1R4 0.33A 3.3X3.3X1.5	22uH	~
L307	3646027	Bottom	G	2	0402_ELJRF	CHIP COIL 33N J Q7/100MHZ 0402	33nH	~
L308	3646027	Bottom	G	3	0402_ELJRF	CHIP COIL 33N J Q7/100MHZ 0402	33nH	~
L356	3645209	Bottom	O	5	COIL_0603CS	CHIP COIL 33N G Q40/250MHZ 0603	33nH	~
L357	3645209	Bottom	N	5	COIL_0603CS	CHIP COIL 33N G Q40/250MHZ 0603	33nH	~
L358	3645161	Bottom	O	6	0603L	CHIP COIL 150N J Q14/100MHZ 0603	150nH	~
L386	3203725	Bottom	R	3	FERRITE_0402	FERRITE BEAD 0R6 600R/100M 0402	600R/100MHz	~

ITEM	CODE	SIDE	X	Y	VALUE	PART NAME	VALUE	VALUE
L500	3646053	Bottom	J	5	0402L	CHIP COIL 4N7 +-0N3 Q28/800M 0402	4n7H	~
L501	3646053	Bottom	J	5	0402L	CHIP COIL 4N7 +-0N3 Q28/800M 0402	4n7H	~
L700	3646069	Bottom	C	7	0402L	CHIP COIL 33N J Q23/800M 0402	33nH	~
L701	3646063	Bottom	B	7	0402L	CHIP COIL 22N J Q28/800M 0402	22nH	~
L702	3646053	Bottom	E	6	0402L	CHIP COIL 4N7 +-0N3 Q28/800M 0402	4n7H	~
L703	3203743	Bottom	E	4	0805_BLM21	FERR.BEAD 0R03 42R/100MHZ 3A 0805	42R/100MHZ	~
L800	3646051	Bottom	E	2	0402L	CHIP COIL 3N9 +-0N3 Q28/800M 0402	3n9H	~
L805	3646009	Bottom	I	4	0402L	CHIP COIL 10N J Q30/800M 0402	10nH	~
L809	3646065	Bottom	I	3	0402L	CHIP COIL 12N J Q31/800M 0402	12nH	~
L810	3646065	Bottom	I	3	0402L	CHIP COIL 12N J Q31/800M 0402	12nH	~
L821	3646059	Bottom	C	2	0402L	CHIP COIL 5N6 +-0N3 Q28/800M 0402	5n6H	~
L824	3646047	Bottom	E	2	0402L	CHIP COIL 3N3 +-0N3 Q28/800M 0402	3n3H	~
M300	6800055	Bottom	G	2	VIBRA_M_KHN5NB1X	VIB MOTOR ASSY 1.3V 105MA 8500	~	~
N100	4341063	Top	S	5	SOT23_5_H1.2	REG 2.8V/150MA LP3985 SOT23-5	~	2.8V
N150	4341345	Top	R	6	USMD_18	AF AMP /(LM4855BLA18AAB) USMD18	~	~
N300	4341309	Bottom	I	7	SOT23L_8	DC/DC CONV 350MA TK11851 SSOP8	~	~
N350	486C004	Bottom	R	7	IRDA_CIM_50M5_T2	IRDA CIM-50M5 1.152MB >2.4V 8PIN	~	~
N356	4341427	Bottom	N	6	HVQFN40	FM RECEIVER TEA5767HN LQFP40	~	~
N500	4370895	Bottom	J	4	uBGA_108_P0.5	HLGA618A TFA3F TFBGA108	~	~
N700	4350383	Bottom	D	5	PW_AMP_RF9219_E1	PWAMP RF9219E2.X 900/1800/1900MHZ	~	~
R100	1430718	Top	R	5	0402R	Resistor 5% 63mW	47R	~
R101	1430718	Top	R	5	0402R	Resistor 5% 63mW	47R	~
R102	1430726	Top	R	5	0402R	Resistor 5% 63mW	100R	~
R103	4120011	Top	R	5	uBGA5	ZDIX4 IP4043CX5 CA 14V2 10W CSP5	~	~
R104	1430812	Top	R	5	0402R	Resistor 5% 63mW	220k	~
R105	1825033	Top	R	6	0402_VAR	CHIP VARISTOR VW14V VC46V 0402	14V/46V	~
R106	1825033	Top	S	6	0402_VAR	CHIP VARISTOR VW14V VC46V 0402	14V/46V	~
R107	1825033	Top	S	6	0402_VAR	CHIP VARISTOR VW14V VC46V 0402	14V/46V	~
R108	1825033	Top	S	7	0402_VAR	CHIP VARISTOR VW14V VC46V 0402	14V/46V	~
R109	1430804	Top	R	5	0402R	Resistor 5% 63mW	100k	~
R111	1430804	Top	S	4	0402R	Resistor 5% 63mW	100k	~
R115	1820039	Bottom	L	5	0402_NTH5	NTC RES 47K J B=4050+-3% 0402	47k	~
R118	1430718	Top	T	4	0402R	Resistor 5% 63mW	47R	~
R119	1430718	Top	T	5	0402R	Resistor 5% 63mW	47R	~
R151	1825033	Top	A	2	0402_VAR	CHIP VARISTOR VW14V VC46V 0402	14V/46V	~
R152	1825033	Top	A	2	0402_VAR	CHIP VARISTOR VW14V VC46V 0402	14V/46V	~
R153	1430137	Top	Q	5	0402R	CHIPRES 0W06 1K0 F 200PPM 0402	1k0	~
R154	1430137	Top	Q	5	0402R	CHIPRES 0W06 1K0 F 200PPM 0402	1k0	~
R155	1620105	Top	Q	5	MNR02	RES NETWORK 0W06 2X2k2 J 0404	2x2k2	~
R156	1430756	Top	Q	5	0402R	Resistor 5% 63mW	1k2	~
R157	1620105	Top	Q	6	MNR02	RES NETWORK 0W06 2X2k2 J 0404	2x2k2	~
R158	1825033	Top	S	5	0402_VAR	CHIP VARISTOR VW14V VC46V 0402	14V/46V	~
R159	1825033	Top	S	5	0402_VAR	CHIP VARISTOR VW14V VC46V 0402	14V/46V	~
R163	1430764	Top	R	6	0402R	Resistor 5% 63mW	3k3	~
R164	1430700	Top	R	6	0402R	Resistor 5% 63mW	10R	~
R165	1430700	Top	R	6	0402R	Resistor 5% 63mW	10R	~
R166	1430700	Top	R	6	0402R	Resistor 5% 63mW	10R	~
R167	1430700	Top	R	6	0402R	Resistor 5% 63mW	10R	~
R171	1430788	Top	Q	5	0402R	Resistor 5% 63mW	22k	~
R176	1430756	Top	Q	5	0402R	Resistor 5% 63mW	1k2	~
R200	1414605	Top	N	7	0805R	CHIPRES 0W25 0R22 J 0805	0R22	~
R202	1430145	Bottom	M	5	0402R	Chipres 0W06 100k F 200ppm 0402	100k	~
R203	1430145	Top	Q	5	0402R	Chipres 0W06 100k F 200ppm 0402	100k	~
R206	1430770	Top	P	4	0402R	Resistor 5% 63mW	4k7	~
R207	1430770	Bottom	M	5	0402R	Resistor 5% 63mW	4k7	~
R211	1430848	Top	L	7	0402R	Resistor 1% 63mW	12k	~
R212	1430215	Top	L	7	0402R	CHIPRES 0W06 68K F 200PPM 0402	68k	~
R301	1430187	Bottom	H	7	0402R	Chipres 0W06 47k F 200ppm 0402	47k	~
R302	1430855	Bottom	J	7	0402R	CHIPRES 0W06 300K F 200PPM 0402	300k	~

ITEM	CODE	SIDE	X	Y	VALUE	PART NAME	VALUE	VALUE
R303	1430121	Bottom	J	7	0402R	Chipres 0W06 22k F 200ppm 0402	22k	~
R306	1430778	Bottom	A	5	0402R	Resistor 5% 63mW	10k	~
R307	1825033	Top	L	4	0402_VAR	CHIP VARISTOR VW14V VC46V 0402	14V/46V	~
R308	1430740	Bottom	B	5	0402R	Resistor 5% 63mW	330R	~
R309	1430740	Bottom	A	5	0402R	Resistor 5% 63mW	330R	~
R311	1430249	Top	L	7	0402R	CHIPRES 0W06 33R F 100PPM 0402	33R	~
R312	1430774	Top	M	7	0402R	Resistor 5% 63mW	6k8	~
R313	1430716	Top	L	4	0402R	Resistor 5% 63mW	39R	~
R314	1430774	Top	L	4	0402R	Resistor 5% 63mW	6k8	~
R315	1430712	Top	A	3	0402R	Resistor 5% 63mW	27R	~
R316	1430770	Top	B	2	0402R	Resistor 5% 63mW	4k7	~
R325	1430691	Bottom	I	7	0402R	CHIPRES 0W06 2R2 J 0402	2R2	~
R350	1413850	Bottom	Q	6	0805R	CHIPRES 0W125 4R7 J 0805	4R7	~
R357	1430792	Bottom	M	6	0402R	Resistor 5% 63mW	33k	~
R358	1430718	Bottom	P	6	0402R	Resistor 5% 63mW	47R	~
R359	1430778	Bottom	O	6	0402R	Resistor 5% 63mW	10k	~
R360	1430804	Bottom	O	6	0402R	Resistor 5% 63mW	100k	~
R361	1430788	Bottom	M	6	0402R	Resistor 5% 63mW	22k	~
R362	1430702	Bottom	M	6	0402R	Resistor 5% 63mW	12R	~
R364	1430700	Bottom	M	6	0402R	Resistor 5% 63mW	10R	~
R367	1430786	Bottom	O	7	0402R	Resistor 5% 63mW	18k	~
R368	1430700	Bottom	O	6	0402R	Resistor 5% 63mW	10R	~
R369	1430792	Bottom	M	7	0402R	Resistor 5% 63mW	33k	~
R372	1430788	Bottom	N	5	0402R	Resistor 5% 63mW	22k	~
R388	4120071	Bottom	Q	5	uBGA8	ASIP EMIF03-SIM01 SIM FILTER BGA8	~	~
R420	1430726	Top	L	3	0402R	Resistor 5% 63mW	100R	~
R421	1430778	Top	M	4	0402R	Resistor 5% 63mW	10k	~
R422	1430873	Top	M	5	0402R	CHIPRES 0W06 27k F 0402	27k	~
R423	1430778	Top	M	4	0402R	Resistor 5% 63mW	10k	~
R450	1430770	Top	O	3	0402R	Resistor 5% 63mW	4k7	~
R500	1430693	Bottom	J	2	0402R	Chipres 0W06 5R6 J 0402	5R6	~
R501	1430754	Bottom	J	1	0402R	Resistor 5% 63mW	1k0	~
R502	1430337	Bottom	J	1	0603R	CHIPRES 0W06 9k1 F 0603	9k1	~
R503	1430770	Bottom	I	5	0402R	Resistor 5% 63mW	4k7	~
R504	1430788	Bottom	I	5	0402R	Resistor 5% 63mW	22k	~
R516	1620033	Bottom	L	5	0404_R	RES NETWORK 0W06 2X5K6 J 0404	2x5k6	~
R517	1620033	Bottom	L	5	0404_R	RES NETWORK 0W06 2X5K6 J 0404	2x5k6	~
R520	1430774	Bottom	L	7	0402R	Resistor 5% 63mW	6k8	~
R522	1430784	Bottom	I	2	0402R	Resistor 5% 63mW	15k	~
R523	1430865	Bottom	K	3	0402R	CHIPRES 0W06 5k6 F 0402	5k6	~
R525	1430770	Bottom	K	3	0402R	Resistor 5% 63mW	4k7	~
R540	1430754	Bottom	I	3	0402R	Resistor 5% 63mW	1k0	~
R702	1430690	Bottom	D	4	0402R	Chipres 0W06 jumper 0402	0R	~
R703	1430714	Bottom	D	7	0402R	Resistor 5% 63mW	33R	~
R704	1430714	Bottom	E	7	0402R	Resistor 5% 63mW	33R	~
R706	1430681	Bottom	B	7	0402R	CHIPRES 0W06 4R3 J 0402	4R3	~
R709	1430754	Bottom	D	3	0402R	Resistor 5% 63mW	1k0	~
R710	1430766	Bottom	D	3	0402R	Resistor 5% 63mW	3k9	~
R713	1430691	Bottom	C	7	0402R	CHIPRES 0W06 2R2 J 0402	2R2	~
R750	1430690	Bottom	E	6	0402R	Chipres 0W06 jumper 0402	0R	~
R800	1430700	Bottom	E	3	0402R	Resistor 5% 63mW	10R	~
R801	1430726	Bottom	E	3	0402R	Resistor 5% 63mW	100R	~
R808	1620031	Bottom	D	2	0404_R_SR	RES NETWORK 0W06 2X1K0 J 0404	2x1k0	~
S300	5200025	Bottom	C	1	SWITCH_SKRE	SM TACT SW SIDE TRAVEL 0.2MM	~	~
S301	5200025	Bottom	E	1	SWITCH_SKRE	SM TACT SW SIDE TRAVEL 0.2MM	~	~
S302	5200025	Bottom	A	6	SWITCH_SKRE	SM TACT SW SIDE TRAVEL 0.2MM	~	~
T500	3640423	Bottom	L	3	TRANS_LDB15	BALUN TRANS 3.7GHZ+/-300MHZ 0805	~	~
T700	4550223	Bottom	E	7	TRANS_LDB15	TRANSF BALUN 1800+-100mhz 2x1.25	~	~
T802	3640431	Bottom	E	3	EHF_FD1774	TRANSF BALUN 1920+/-70MHZ 0805	~	~

ITEM	CODE	SIDE	X	Y	VALUE	PART NAME	VALUE	VALUE
V100	4113721	Top	R	3	CASE_457	TVS DI 1PMT16AT3 16V 175W PWRMITE	~	~
V300	4110475	Bottom	H	7	EMD2	SCH DI RB521S-30 200MA 35V SOD523	~	~
V311	4219937	Top	M	7	SOT_363	TRX2 UMT1/PUMT1 P40V100MA SOT363	~	~
V312	4219921	Top	M	7	EM3	TR DTC143ZE N RBE4K7/47K 0A1 SC75	~	~
V313	4219937	Top	L	4	SOT_363	TRX2 UMT1/PUMT1 P40V100MA SOT363	~	~
V314	4219921	Top	L	3	EM3	TR DTC143ZE N RBE4K7/47K 0A1 SC75	~	~
V317	4219937	Top	B	2	SOT_363	TRX2 UMT1/PUMT1 P40V100MA SOT363	~	~
V318	486B012	Bottom	A	3	LED_SMD2_R	LED ZW Y87C-S2T2-35-0-20	~	~
V319	4860315	Bottom	A	3	LED_LWY87C	LED LWY87C-S2T2-1 >224 WHITE SMD2	~	~
V320	4219921	Top	L	4	EM3	TR DTC143ZE N RBE4K7/47K 0A1 SC75	~	~
V356	4110965	Bottom	O	5	SOD_523	CAP.DI BB202 CT=2.5 FM 0R8 SOD523	~	~
V357	4110965	Bottom	N	5	SOD_523	CAP.DI BB202 CT=2.5 FM 0R8 SOD523	~	~
V801	4219903	Bottom	C	2	SOT_363	TRX2 BFM505 N 20V 18MA 9GHZ SOT363	~	~
V802	4210261	Bottom	E	2	SOT_363	TR BGA428 LNA1.8GHZ 19.5DB SOT363	~	~
X100	5409253	Bottom	G	6	LYNX_BATT_CONN	SM BATTERY CONN 3POL SPR 12V 2A	~	~
X301	5469135	Top	L	6	CPBT_297884_6	SM CONN 2X8 SPR 50V 0.5A PCB/PCB	~	~
X302	5469175	Top	B	6	CON_DF23C_10DS	SM CONN BTB 2X5 F P0.5	~	~
X386	5400085	Bottom	O	3	SIM_READER_HD940	SIM CARD READER 2X3POL P2.54 SM	~	~
Z300	4120031	Top	L	5	uBGA24	EMI/ESD FILT EMIF10-1K010F1 BGA24	~	~
Z700	4511337	Bottom	C	7	DCC6D_H1.225	SAW FILT 897.5+-17.5MHZ/2.6DB 3X3	897.5MHz	~
Z800	4550241	Bottom	C	3	ANT_SW_LMZ0135_8C	ANT.SW+2SAW 880-960/1710-1990 MHZ	~	~
Z806	4511339	Bottom	D	2	DCS4D_H1.0	SAW FILT 1960+-30MHZ/2.7DB 2X2.5	1960MHz	~

